

elia

## Ultrasonic diffuser

EN

*Instructions for use*

## Precautions for use:

EN

- Before you use the devices, read carefully and keep the operating instructions described below. Always make sure that you properly handle the devices. Throughout this instruction manual, the term «device» refers to the diffuser and its accessories.

- If you notice a burning smell or the product shows other signs of significant malfunction, immediately disconnect the power cord from the electrical outlet. Wait until the burning smell dissipates, then contact your retailer.

- If the device falls, disconnect the power cord from the electrical outlet.

- Maintain the essential oil diffuser with an appropriate cleaner available at your retailer.

- Do not try to disassemble or modify the devices.

You will be exposed to hazards and your 2-year parts and labour warranty would become invalid.

- Do not bend, twist or pull the power cord, this may damage it and cause a fire or electrical shock hazard.

- Do not place heavy objects on the devices.

- Do not plug the diffuser output of your device.
- Do not use the devices in areas that are smoky, humid, dusty, or subject to strong vibrations.
- Do not expose the devices to high temperatures.
- Keep the devices out of the reach of children.
- Do not diffuse for more than 10 min. in a child's room in their presence.
- Do not use the devices near an open flame.
- Do not use the devices in a humid atmosphere. Do not immerse the devices in water.
- Carefully observe the precautions for use provided with the bottles of essential oils.
- Do not overfill the essential oil diffuser. They could stain the furniture on which they are placed.
- Maintain the essential oil diffuser with an appropriate cleaner available at your retailer.
- Do not place the diffuser on an inclined or unstable piece of furniture. It could fall, break and cause injury.
- Keep the devices out of the reach of children.
- This device can be used by children 8 years of age and older and by persons with limited physical, sensory or mental abilities or without experience or

knowledge of the device, if they are properly supervised or if the instructions relating to the safe use of the device were given to them and the associated risks were understood.

- Children must not play with this device.
- Cleaning and maintenance must not be performed by unsupervised children.
- Only use substances recommended for diffusion in the device. Using other substances may cause a toxic hazard or risk of fire.
- The device may only be used with the power adapter provided.
- Unplug the device before handling or maintenance. Make sure that it has been emptied of any liquid or substance for diffusion.
- The device must only be powered using very low voltage for safety reasons, which corresponds to the device marking.
- This instruction manual and spare parts are available on [www.innobiz.fr](http://www.innobiz.fr)
- If the power cable is damaged, it must be replaced

with a cable or special kit available from the manufacturer or after sales support.

- Unplug the device whilst filling or cleaning.
- Do not put too much water. Observe the maximum filling level indicated by the mark on the device. In case of surplus, empty the excess and immediately wipe with a soft cloth the plastic parts that may have been in contact with the water and essential oil.
- Use a cloth dampened with water and white vinegar to clean and descale your device. Then dry it with a soft clean cloth.
- When using the device, pay attention to the emission of hot water vapour.



*The crossed-out wheellie bin symbol affixed to the product or its accessories indicates that they are classified as electrical and electronic equipment.*

*As such, the European regulations require it is collected separately from other waste:*

- by distributors, if an equivalent product is purchased,
- using the locally-available collection facilities (waste reception centre, separate collection, etc.)

*In this way, you will be helping to reuse and recycle*

*Waste Electrical and Electronic Equipment that could have potentially harmful effects on the environment and on human health.*



*This appliance satisfies the European Community requirements concerning safety, hygiene, the environment and consumer protection.*

*This essential oil diffuser uses the mist diffusion method. Just a few drops (maximum 15) of essential oils, added to the water, are enough to diffuse their fragrances and benefits throughout your interior.*

### **Contents:**

- 1-** The diffuser Elia
- 2-** A mains adapter
- 3-** Instructions for use.

Céralia is composed of the following elements:

- A.** A top cover
- B.** A base, with:
  - 1. A ceramic disc
  - 2. A maximum water level (100 ml)
  - 3. An air outlet
  - 4. An on/off switch included on the underside of the product
- C.** A mains adapter

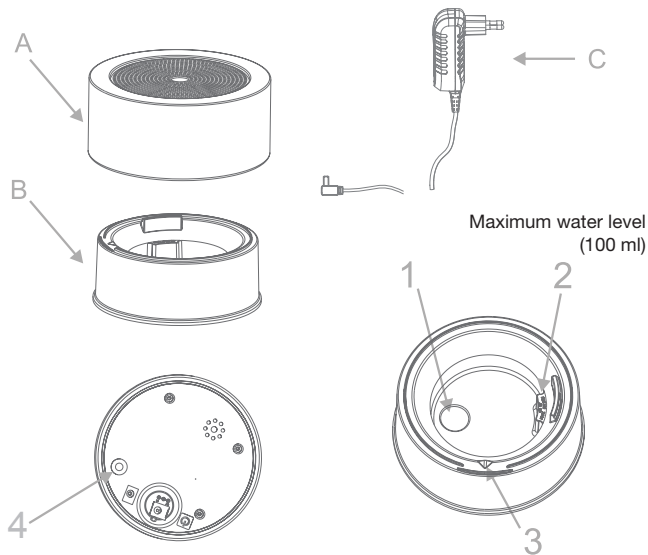

- 1. The device must be placed on smooth, horizontal surface.*
- 2. Connect the mains adapter (C) to the diffuser, without plugging it into the mains.*
- 3. Remove the top cover (A).*
- 4. Use tap water at room temperature (do not use demineralized water) to fill the reservoir in the base (B) with a maximum of 100 ml (do not fill higher than the maximum water level mark [2]).*
- 5. Add between 5 and 15 drops (maximum) of the essential oils to be diffused to the water.*
- 6. Put the top cover (A) back on the base (B).*
- 7. Plug the mains adapter (C) into a mains socket.*
- 8. To turn your Céralia on, press the top of the device. This gesture will activate the on/off switch on the underside of the device.*

*Successively pressing the device will provide several operating modes:*

- 1<sup>st</sup> press:** *diffusion of mist + lights with changing colors*
- 2<sup>nd</sup> press:** *diffusion of mist + fixed light in the last color that appeared*
- 3<sup>rd</sup> press:** *diffusion of mist without light*
- 4<sup>th</sup> press:** *the device turns off (neither mist nor light)*



**DO NOT FILL HIGHER THAN THE  
MAXIMUM WATER LEVEL MARK**

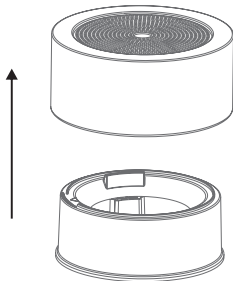

**3. Remove the top cover**

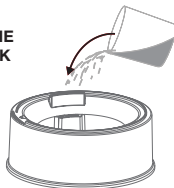

**4. Fill the reservoir  
(max 100 ml)**



**5. Add between 5 and 15 drops  
of essential oils to the water**

## Maintenance:

EN

1. Make sure that your device has been switched off.
2. Unplug the mains adapter (C) from the mains socket; then disconnect the mains adapter (C) from the base (B) of your Elia.
3. Remove the top cover (A).
4. Empty out any water remaining in your Elia.
5. Use a cotton bud or soft, clean cloth to clean the inside of the device. Take care not to press too hard on the ceramic disc (1) as this element is fragile.

It is recommended that this cleaning process be carried out after every 3rd use.

## Specifications:

EN

- Mains operated, 100-240 V
- Dimensions: diameter = 150 mm, height = 65 mm
- On/off button included on the underside of the product
- Water level detector and automatic switch-off when the level is low

Distributed by **INNOBIZ**

300 H rue du Clos de Viviers – 34830 Jacou – France

[www.diffuser-manufacturer.com](http://www.diffuser-manufacturer.com)

Model: ELIA - Made in PRC

## Troubleshooting:

EN

If the product is knocked over by mistake when in use, the water may spill out into the base (B).

If this is the case, unplug the mains adapter (C), empty out as much of the water as you can and leave the diffuser to dry in a vertical position, in a dry, well-ventilated area, for at least 3 days. After this, if you notice any dysfunction, ask your retailer for advice.

If your Elia no longer produces any mist, here are a few possible explanations and their respective solutions:

- 1.** Your Elia is not plugged in. Make sure that there is a good connection with the diffuser and that your mains plug is working correctly.
- 2.** There is no more water (or not enough). In this case, add water without exceeding the maximum level (2).
- 3.** There is too much water. Make sure that you do not exceed the maximum water level (2) and empty out any excess water.
- 4.** The lid is blocked by water droplets or other particles. Clean the lid thoroughly and make sure that the air outlet (3) is clear.