

wellmo

BATHROOM MIRROR DEFOGGER INSTALLATION INSTRUCTIONS

SAFETY POINTS

1. WELLMO Defogger is to be used as a bathroom mirror defogger only. Install in accordance with these instructions. Any other use is not recommended.
2. Installation is not difficult and conforms to standard industry practice. As with any electrical product, we do recommend installation be performed by a qualified person in accordance with local building and electrical codes. Disconnect power at the fuse breaker panel before installation.
3. HANDLE WITH CARE: **DO NOT CUT, PUNCTURE, USE STAPLES OR NAILS TO MOUNT.** The heating element of mirror defogger should never be cut or damaged. This will render the product useless. It cannot be repaired. Please take particular care not to damage the element. (You may trim the excess material as long as the actual heating element is NOT damaged. This is common for WELLMO oval and round series. Round and Oval Defoggers may have excess adhesive backing material trimmed not closer than 20 mm from the electrical heating grid component.)
4. The power supply cable of the defogger should not be pulled or drawn forcefully, this may cause damage to the defogger.

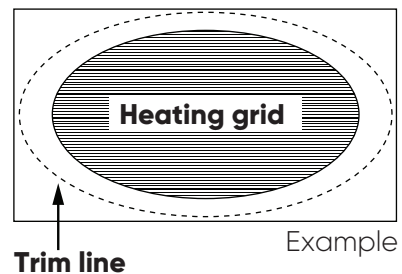

FITTING THE HEATER TO THE MIRROR

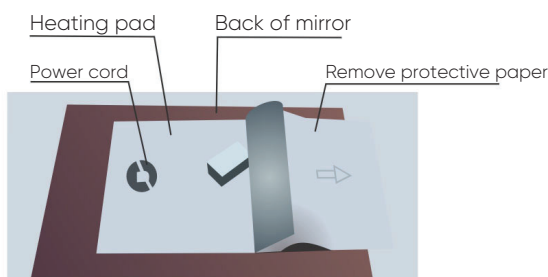

1. Adhere the heater to the back of the mirror, NOT to the wall.
2. Always handle mirrors with care. Lay the mirror face down on a padded surface.
3. The back of the mirror must be absolutely clean, dry and grease free.
4. Peel off the protection paper approximately ten centimeters and fold paper back, adhere the heater with self-adhesive backing, directly onto the back of the mirror. Use towel or other soft materials to press the back of the defogger, as you pull off the rest of the protective paper. Be careful not to leave air-bubbles between mirror and defogger.

INSTALLING THE HEATED MIRROR ONTO THE WALL

The heated mirror can be installed on walls made of wood, ceramic tile, marble, etc. Walls must be dry, stable, and smooth.

The heated mirror should be wired directly into wall circuit.

Before installation mirror, apply clear silicon around the mirror with applicator onto the surface of wall of choice. Or if the mirror rests on clips, place a layer of silicon on the bottom of the clips.

Please allow a 2 mm gap between the mirror and hard substances (e.g. ceramic brick, marble, tiles as well as metal and wood periphery around mirrors) If you have metal periphery, please ensure the mirror is grounded according to local regulations. (This may require a GFI circuit).

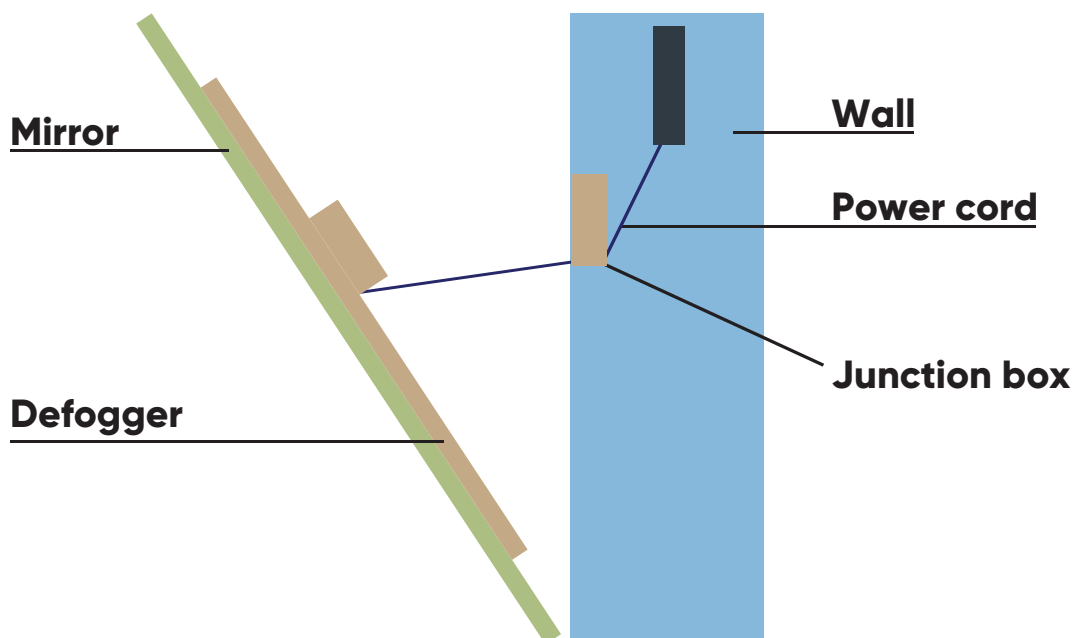

ELECTRICAL INSTALLATION INFORMATION

Connect the wires of the defogger according to local regulations. (This may require a GFI circuit).

The power supply cable may be connected to the vanity lighting switch circuit. The heater should be switched. It is recommended heaters be switched with bathroom lights to turn on and off with the lights.

Fix the mirror onto wall by silicon or clips, then apply neutral silicon again to seal around the edge of the mirror, which is the same way with normal mirror.

Switch the power on and test the mirror. In approximately 3-5 minutes, the mirror should become warm.