

Smart Sprinkler Timer

USER GUIDE

ZIGBEE

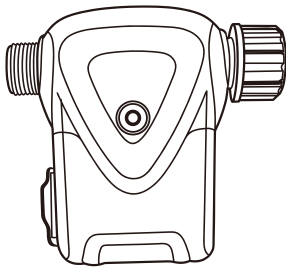

Specifications

Power supply: AA 1.5V * 4
Water pipe size: 3/4 inch
Thread specification: NPT, BSP optional
Standby power consumption: 42uA
Communication protocol: Zigbee 3.0
Wireless protocol: Zigbee IEEE 802.15.4
Wireless distance: 45M
Flow rate range: 1-35L/min
Waterproof grade: IP66
Working water pressure: 0.03MPa~0.9MPa
Working temperature: 1-60 °C (34-140 °F)
Working humidity: 1%~95% RH (non condensing)
Size: 137mm X 126mm X 54mm

01

Product Configuration

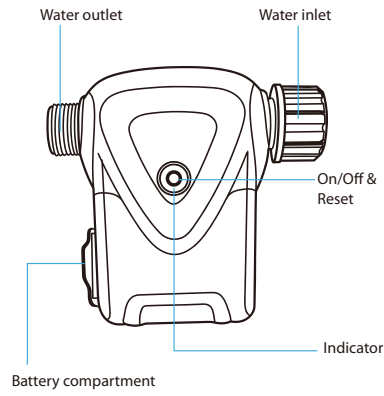

02

Installation and use

1. Installation diagram

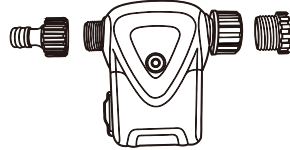

Please purchase connectors according to the actual environment.

2. Installation Steps

① According to the picture below to install the accessories and the device complete.

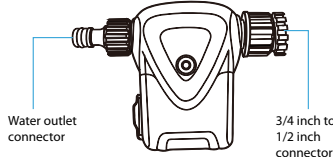

03

② Close the water pipe valve and connect the equipment connected in step ① to the water valve

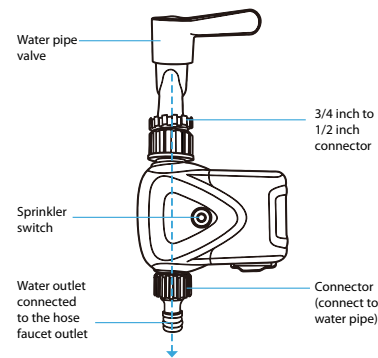

04

③ After installation, open the water pipe valve and pair the equipment distribution network to the APP according to the instructions to use it

3. Battery replacement

Note: ① Insert 4xAAA standard alkaline batteries into the terminals. Observe + position.
②When inserting back into the battery compartment, pay attention to the direction of the shrapnel, and maintain the same orientation as the pouring switch button/indicator light

(1) Remove the screw (2) Take out the battery compartment

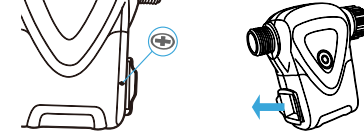

(3) Install 4xAAA battery, Replace the battery compartment.

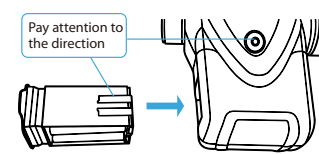

05

4. Installation cautions

(1) Pay attention to the direction of the water inlet/outlet during installation and do not reverse it
(2) Keep the product away from fire and heat sources. Do not expose products containing batteries to excessive heat (e.g., from storage in direct sunlight, fire, or the like).
(3) Do not place magnetic materials near the equipment

06

LED State

Device Status	LED State
To be pairing	The indicator flashes twice per second
Resting	Long press and hold the reset button for 7 seconds

07

Get Started

1. Download APP

Android system: Download the "Smart Life" APP at Google Play;
iOS system: Download the "Smart Life" APP from the Apple Store.



08

2. Register and Login

2-1 Launch the "Smart life" app.
2-2 To register, enter your mobile phone number or email address, create a password, then login to the app.
2-3 Login if you have an account already.

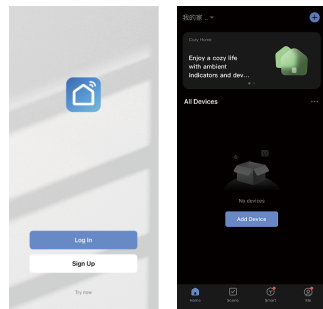

09

3. Add Devices

3-1. Add ZigBee Gateway
Add Tuya ZigBee gateway firstly, please follow the gateway instructions (distinguish wired gateway and wireless gateway).

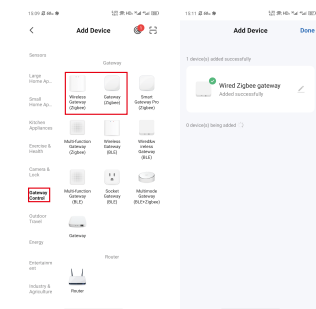

10

3-2. Add Sub-devices

Before adding a sub-device, ensure that the device is in the pairing state (flashing indicator). If the device is not in the pairing state, press the reset button for 7 seconds

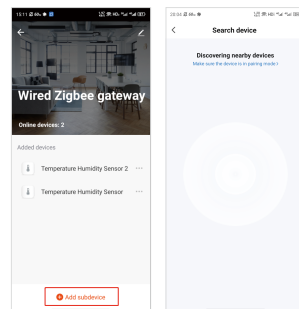

11

Functions and Settings

App Main interface

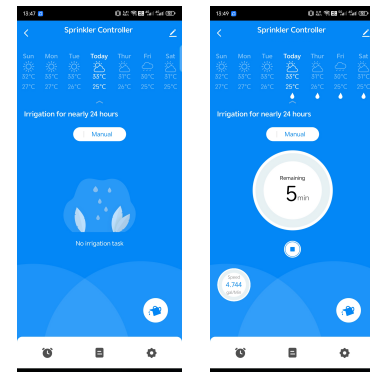

12

1. Turn on the flow meter function

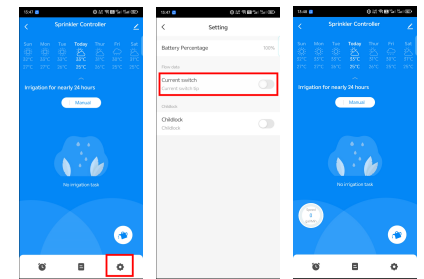

13

2. Watering Switch

① Countdown Watering (Maximum duration 4 hours)

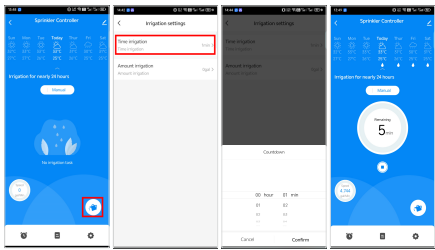

14

② Quantitative watering

(this function is not displayed when the flow meter setting is not turned on)

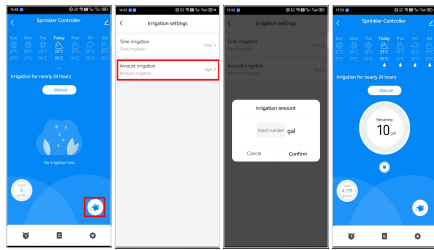

15

3. Timing watering

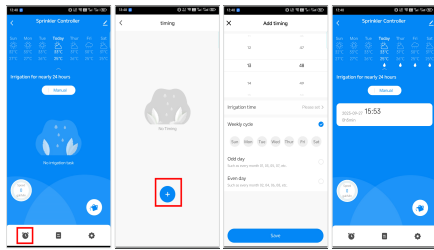

16

4. Watering records

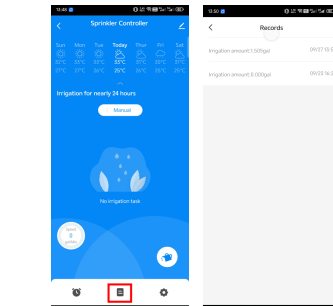

17

5. Function setting

① Battery level

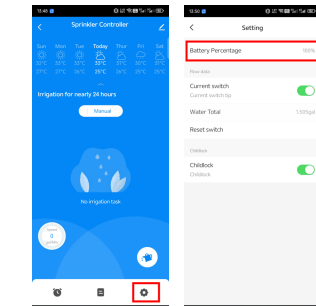

18

② Flowmeter switch

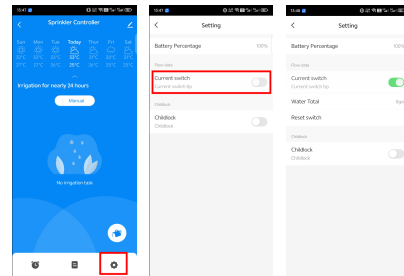

19

③ Total water consumption
(the flow meter function needs to be turned on first)

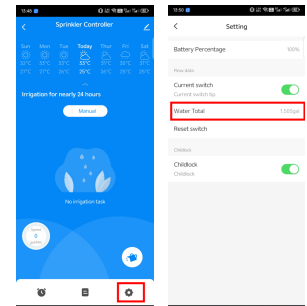

20

④ Clear the total flow rate
(the flow meter function needs to be turned on first)

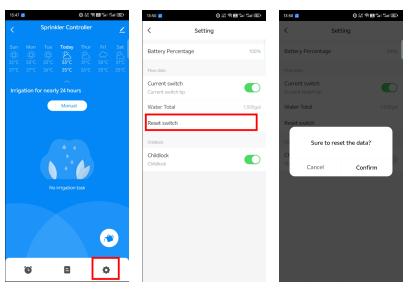

21

⑤ Child lock
(local button switch is not supported after opening the child lock)

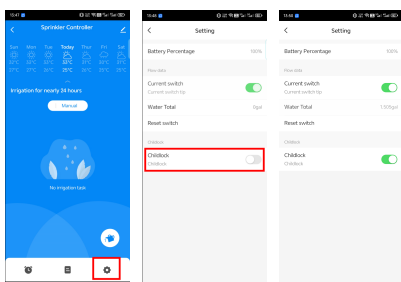

22

Other Function

1. Scenario linkage

For example: when the temperature and humidity are detected to be below 50%, the linkage opens the watering, and the countdown watering is 5 minutes

Note: The device supports LAN linkage; Two or more devices under the same gateway are set up for linkage. When the gateway is disconnected, the linkage will continue to execute

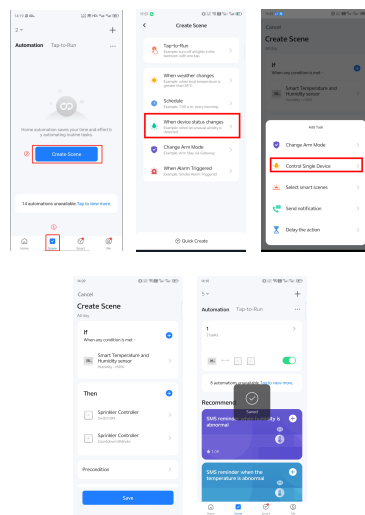

24

2. Sharing device

Zigbee device only supports homegroup sharing

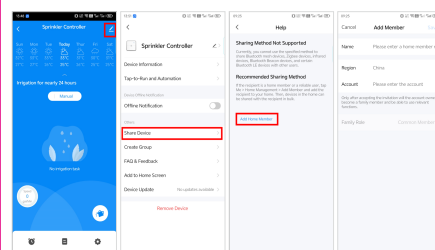

25

3. Clear record

By deleting devices through the app and adding them again, you can clear device records and restore default settings

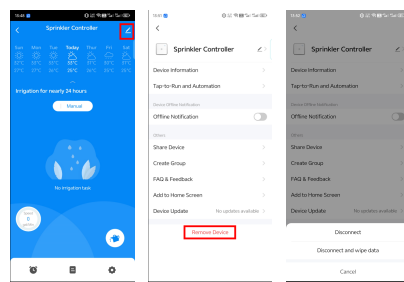

26

Due to the app update, the above interface is for reference only