

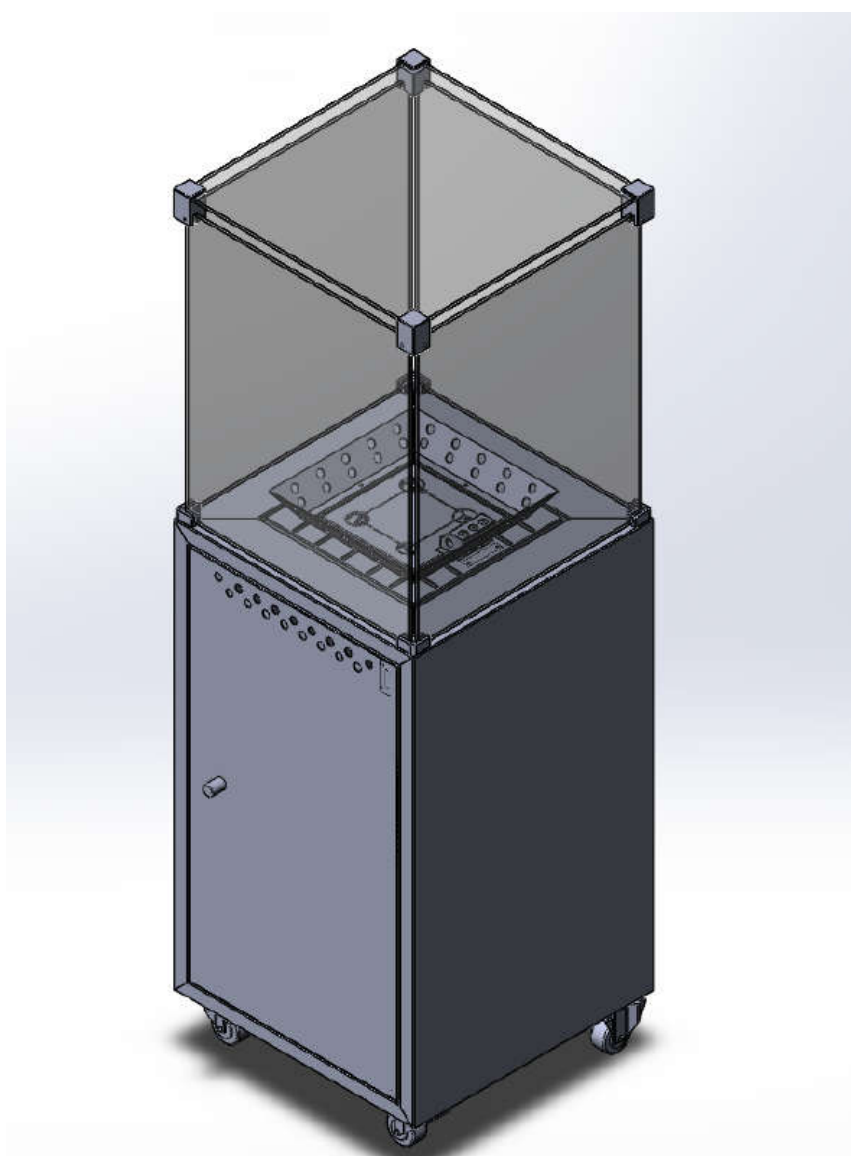

Gas Fire Patio Heater

ETNA



Instruction Manual (EN)

Please read the manual BEFORE you unpack or install the fire

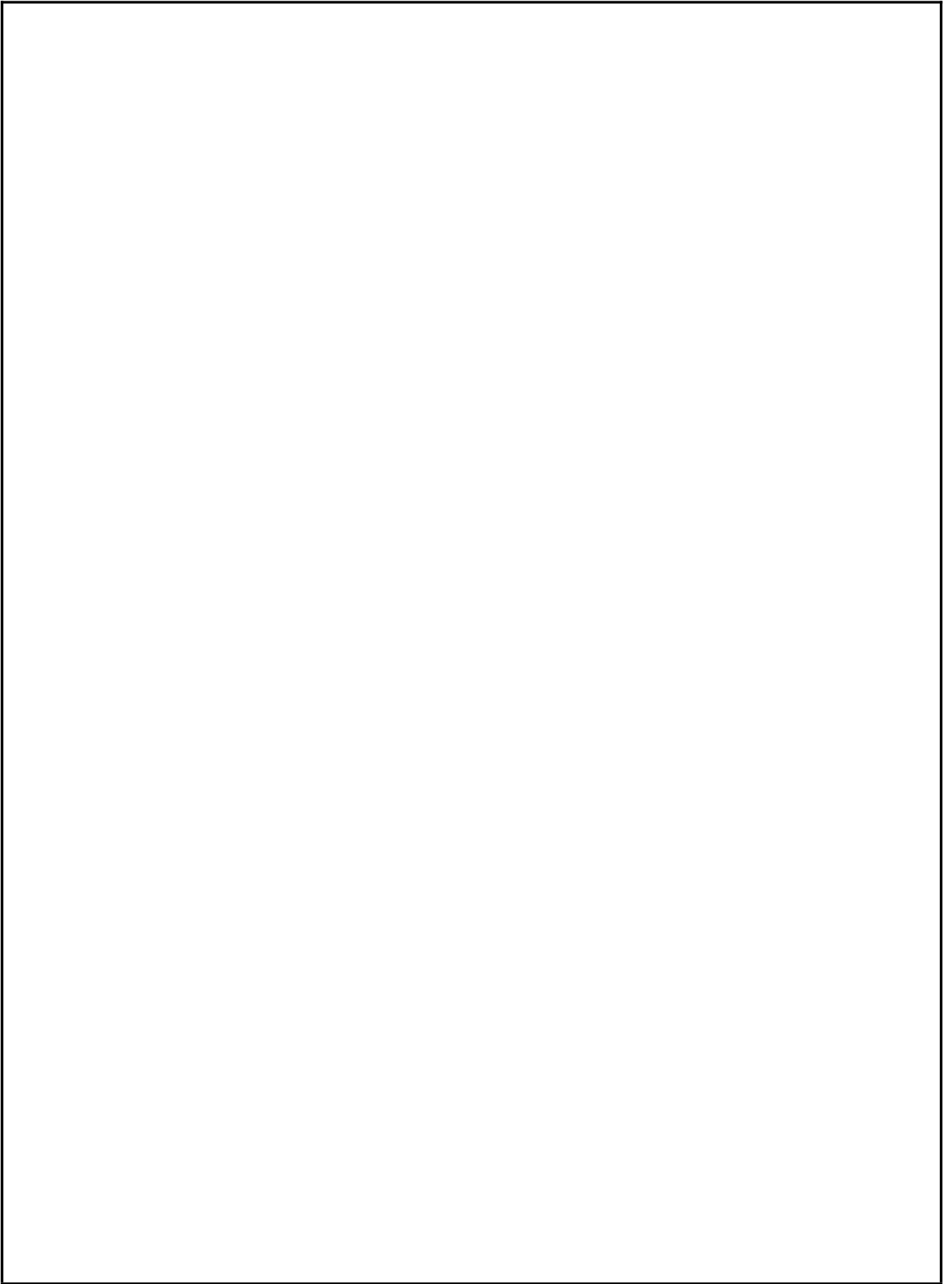

TABLE OF CONTENTS

Warning	4
Warning	5
Specifications	6
Getting Started	7
What's Included	7
Exploding Drawing	8
Part List	9
Assembly Procedures	10&11
Product Drawing	12
Heater Stand and Location	12
Gas hose & regulator	13
Gas Requirements	13
Leakage Test	14
Lighting Instructions	14
After Use and Storage	14
Cleaning and Maintenance	15
Troubleshooting Checklist	15&16
Spare Parts	16
Warning	17
Warranty	18
Contact	20

WARNING

**PLEASE READ CAREFULLY THE FOLLOWING SAFETY GUIDELINES BEFORE OPERATION AND INSTALLATION
REPAIRS SHOULD ONLY BE DONE BY A QUALIFIED TECHNICIAN**

- Do not use this appliance for indoors, as it may cause personal injury or property damage. THIS APPLIANCE MUST ONLY BE USED OUTDOORS.
- Do not connect the heater to any gas supply until it has been fully assembled.
- This outdoor heater is not intended to be installed on recreational vehicles and/or boats.
- Appliance should be located on a solid surface.
- Maintenance and repair should be carried out by a qualified technician.
- Improper installation, adjustment, alteration can cause personal injury or property damage.
- Do not attempt to alter the unit in any manner. Any modifications may be dangerous and are not permitted.
- Do not store or use petroleum or other flammable vapors or liquids in or near the heater unit.
- The whole gas system, hose, regulator, pilot or burner should be inspected for leaks or damage before use, and at least annually by a qualified technician.
- All leak tests should be done with a soap solution. Never use an open flame to check for leaks.
- Do not use the heater until all connections have been leak tested.
- Turn off the gas valve if smell of gas is detected and immediately shut off any gas supply.
- Do not move heater while it is operation.
- Do not move the heater until temperature has fully cooled after it has been turned off.
- Control compartment, burner and circulation air passageways of the heater must be kept clean.
- Frequent cleaning may be required as necessary.
- All gas cylinders should be turned off when the heater is not in use.
- Check the heater immediately if any of the following occurs:
 - The heater does not reach temperature.
 - The burner makes popping noises during use (a slight noise is normal when the burner is extinguished).
 - Smell of gas in conjunction with extreme yellow tipping of the burner flames.
 - The burner does not ignite or continues to go out
- The gas regulator and hose assembly must be located in the cylinder cabinet where gas cylinder is installed.
- Any guard or other protective device removed for servicing the heater must be replaced before further use.
- Adults and children should stay away from high temperature surfaces to avoid personal injury or property damage. WARNING: Accessible parts may be very hot.
- Children should be carefully supervised at all time when they are in the area of the heater.
- Clothing or other flammable materials should not be hung on the heater or placed on or near the heater.
- Do not use the heater for any form of cooking.
- Do not throw anything into the heater.
- Do not leave the heater unattended whilst in operation.
- Do not use heater in excessively windy conditions.
- Do not use heater in excessively rainy conditions, as this could lead to damage to components.
- Ensure the gas supply is isolate and shut off when not in use and gas control valve is in the OFF position.
- Follow all instructions regarding the use of LPG and Butane bottles. Please contact your local gas supplier for further advice if needed.
- WARNING: Flames from the heater are almost invisible in direct sunlight.

Warning

1, The regulator shall comply with the standard EN16129;

For category I3+, the appliance shall use the butane 30mbar regulator (reduce pressure:28-30mbar) or the propane 37mbar regulator (reduced pressure: 37mbar).

For category I3B/P(30), the appliance shall use the LPG 30mabar regulator(reduced pressure:28-30mbar).

For category I3B/P(50), the appliance shall use the LPG 50mabar regulator (reduced pressure:50mbar).

2, The hose shall comply with the standard EN 16436 and the length of the hose should not exceed 1.5m.

3, The minimum distance from non protected combustible materials shall be 2m.

4, To change the gas cylinder in a amply ventilated area, away from any ignition source (candle, cigarettes, other flame producing appliances, ...).

5, To check that the regulator seal is correctly fitted and able to fulfil its function.

6, Do not obstruct the ventilation holes of the cylinder housing.

7, Close the gas supply at the valve of the gas cylinder or the regulator after use.

8, In the event of gas leakage, the appliance shall not be used or if alight, the gas supply shall be shut off and the appliance shall be investigated and rectified before it is used again.

9, Check the tubing or the flexible hose (at least once per month and each time the cylinder is changed).

If it shows signs of cracking, splitting or other deterioration it shall be exchanged for new hose of the same length and of the equivalent quality;

10, Read the instructions before installation and use.

11, This appliance must be installed and the gas cylinder stored in accordance with the regulations in force.

12, Do not obstruct the ventilation holes of the cylinder housing.

13, Do not move the appliance when in operation.

14, Shut off the valve at the gas cylinder or the regulator before moving the appliance.

15, The tubing or the flexible hose must be changed within the prescribed intervals.

16, Use only the type of gas and the type of cylinder specified by the manufacturer.

17, In case of violent wind particular attention must be taken against tilting of the appliance,

18, Keep the instructions for future reference.

19, Do not connect the gas cylinder directly to the appliance without regulator.

20, The tubing or the flexible hose must be changed within the prescribed intervals.

21, Use only the type of gas and the type of cylinder specified in these instructions.

22, The injector is assembled by manufacturer only.

Specification

The gas fireplace is designed to work with the following gas types.

Model:	Qogir MKIII (ETNA)		
Appliance categories:	<input type="checkbox"/> I ₃ +	<input type="checkbox"/> I ₃ B/P(30)	<input type="checkbox"/> I ₃ B/P(50)
Type of gas:	Butane / Propane	LPG mixtures	LPG mixtures
Gas pressure:	Butane : 28 – 30 mbar Propane : 37 mbar	28-30 mbar	50 mbar
Total heat input:	7.3 kW (G30:531 g/h G31:522 g/h)	7.3 kW (531 g/h)	7.3 kW (531 g/h)
Injector size:	1.32 mm (Pilot: 0.25 mm)	1.32 mm (Pilot: 0.25mm)	1.18 mm (Pilot: 0.18mm)
Countries of destination:	BE, CH, CY, CZ, ES, FR, GB, GR, IE, IT, LT, LU, LV, PT, SK, and SI	BE, BG, CY, DK, EE, FI, FR, HR, HU, IS, IT, LT, LU, MT, NL, NO, RO, SK, SI, SE and TR	AT, CH, DE and SK
PIN:	0063CS7870		
Serial number:			
This appliance is not for domestic use.			
WARNING: Accessible parts may be very hot. Keep young children away.			
Read the instructions before using this appliance. The appliance must be installed in accordance with the instructions and local regulations			
Close the valve of the gas cylinder or the regulator after use.			
The use of this appliance in enclosed areas can be dangerous and is PROHIBITED.			
For use outdoors or in amply ventilated areas. An amply ventilated area must have a minimum of 25 % of the surface area open. The surface area is the sum of the walls surface.			

**0063**



GETTING STARTED

Please read instruction thoroughly before using the appliance.

The gas heater will arrive in one box containing the appliance with burner already installed, castor wheels, surrounding safety glass, glass or lava rock fuel beds.

Remove the appliance from packaging. Carefully place it down on the floor, keeping it upright for ease of assembly.

Extreme care should be taken when handling the heater, to ensure the gas pipes, thermocouple lead, gas valve or burner are not damaged or loosened in anyway.

Please note: ALL heaters have been burn tested and leak tested prior to leaving the factory. Although each unit is cleaned, there may be the odd scorch mark around the pilot and main burner gas jets.

WHAT'S INCLUDED

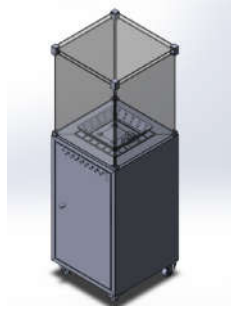
Appliance Heater	
Castor Wheels	
Surrounding Safety Glass and Brackets	
Glass Bead & Lava Rock Fuel Beds	

Exploding Drawing

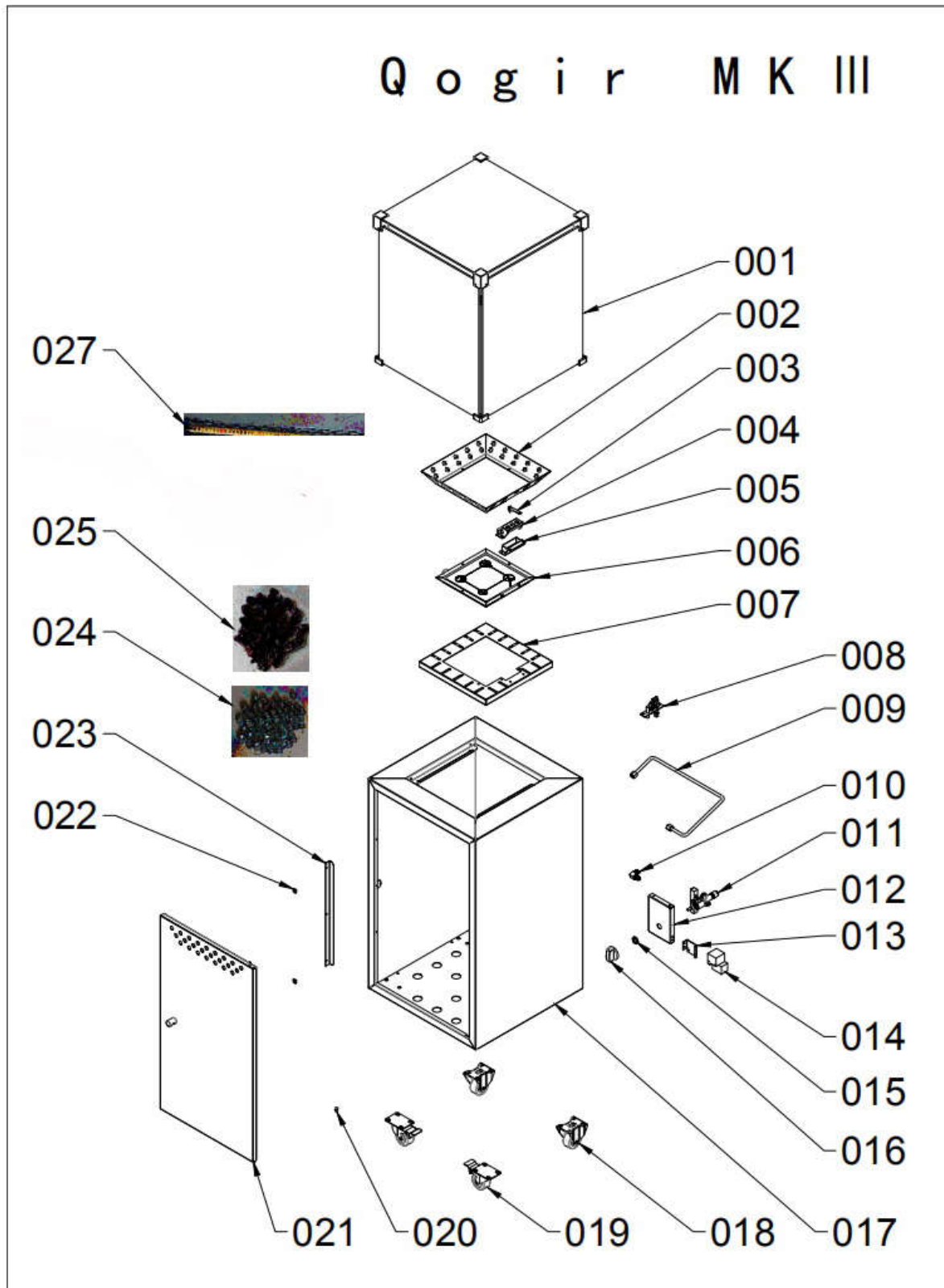

Qogir MKIII Part List		
Part No.	Part Name	QTY
001	Top glass assembly	1
002	Burner shield	1
003	Flame guide	1
004	Pilot shield	1
005	Pilot bracket	1
006	Burner	1
007	Burner bracket	1
008	Pilot	1
009	Alu pipe assembly	1
010	Injector assembly	1
011	Gas valve	1
012	Gas valve bracket	1
013	Overturn shut off switch bracket	1
014	Overturn shut off switch	1
015	Gas valve fixed nut	1
016	Knob	1
017	Bottom cabinet assembly	1
018	Wheels without break	2
019	Wheels with break	2
020	Hinge	1
021	Door Assembly	1
022	Magnet	2
023	Door stop	1
024	Glass beads	2.1 kg
025	Lava rock	1kg
027	Gas tank chain	1

ASSEMBLY PROCEDURES

Remove the heater body and all of the parts from carton, then follow below procedures.

STEP 1 – Attach Cabinet Handle

Attach cabinet screw handle in the hole in the rear panel.



STEP 2 – Attach Castor Wheels

With at least two people carefully tilt the appliance on to its side to attach the castor wheels.

Using a spanner attach to the castor wheels to base of appliance with supplied nuts and washers.

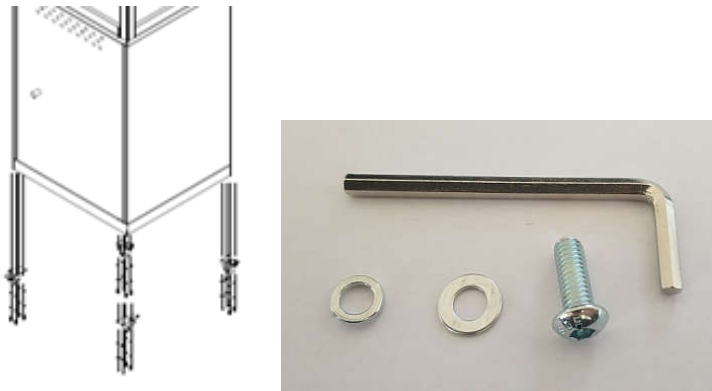

STEP 3 – Adding Fuel Bed

Note: for this step you will need a small step ladder or platform to give extra height as the fuel beds need to be installed from the top of the appliance.

Glass or Lava Rock for Pan Burner

This should be done outside.

Cover the burner with either glass or lava rock fuel beds. DO NOT tip the bag of glass or lava rock onto the burner as the bags usually contain some fine dust which could clog the burner jets. It is better to empty the bags into a suitable container and then place the glass or rock by hand around the burner. Make sure the area around the pilot light is kept clear to allow air to reach.

Positioning of Glass or Lava Rock on the Burner – Keep Pilot Area Clear



STEP 4 – Installing Surrounding Safety Glass

Using a HEX Key fix the surrounding safety glass together with the supplied glass brackets and screws around the sides of the burner. Then using a HEX Key fix the top safety glass to the top of appliance with the supplied glass brackets and screws. This will need to be done with two people.

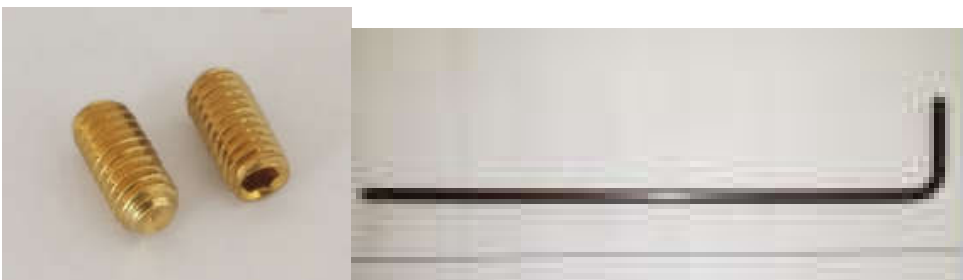
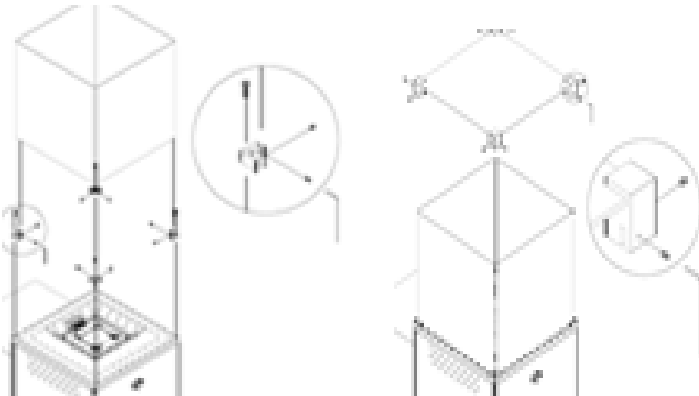

PRODUCT DRAWING

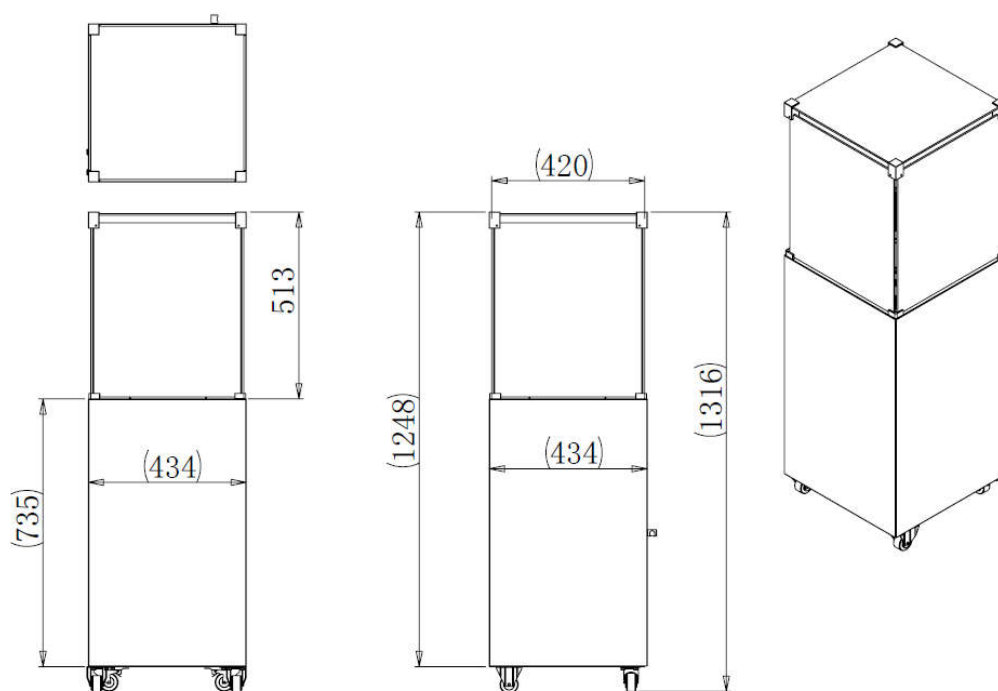

HEATER STAND AND LOCATION

- The heater is for outdoor use only. Always ensure that adequate ventilation is provided.
- Always maintain proper clearance to combustible materials of at least 2 metres.
 - Do not place near to your house.
 - Do not place near to shed, garage or fences.
 - Do not place under roof covering or low overhanging trees
 - Do not place near to power sources or under overhanging power cables.
- Heater must be placed on level firm ground. Ensure that castor wheels are locked into place.
 - The appliance is fitted 'Overturn Shut Off Device'. If the appliance is tilted or does not stand vertically or was to fall over it will automatically shut off gas supply and appliance would shut down.
- Never operate heater in an explosive atmosphere where petroleum or other flammable liquids and gases are stored.

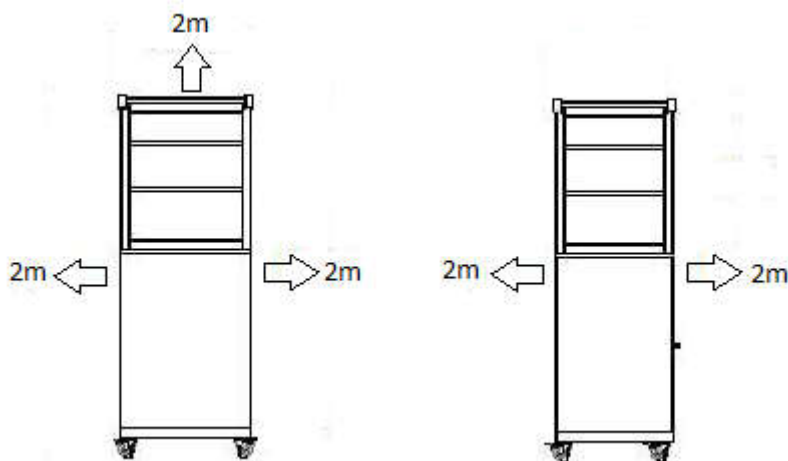

Gas hose & Regulator

Regulators and hose must comply with EN16129, EN16436-1 and EN16436-2 , in additional to applicable national regulations.

WARNING!!!

It's extremely important that you DO NOT route the gas hose under the directly under burner. Do not allow the hose to touch any part of the burner or heater. The hose should be located so that it is not subjected to undue strain or placed where is could be damaged.

GAS REQUIREMENTS

- Use propane or butane gas only.
- Always use the correct pressure regulator and hose assembly suitable for the gas cylinder. Contact your local gas supplier for further advice if needed.
- Dented, rusted or damaged gas cylinders may be hazardous and should be checked by your gas supplier.
- Never use a cylinder with a damaged valve connection.
- Never connect an unregulated gas cylinder to the heater.

Maximum Gas Bottle Size

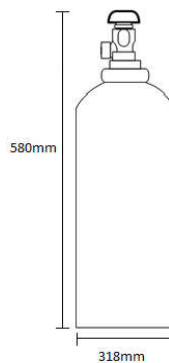

Notice-Gas bottle Chain

When the gas bottle placed in cabinet, you must be hing on the door chain as below picture.



LEAKAGE TEST

Gas connections on the heater are leak tested at the factory prior to shipment. A complete leakage test should be performed at the installation due to possible mishandling in shipment or excessive pressure being applied to the heater.

- Make a soap solution of one part liquid detergent and one part water. The soap solution can be applied with a spray bottle, brush or rag. Soap bubbles will appear in case of a leak.
- The heater must be checked with a full cylinder.
- Make sure the safety control valve is in the 'OFF' position.
- Turn the gas supply from the cylinder ON.
- In case of a leak, turn off the gas supply. Tighten any leaking fittings, then turn the gas supply on and recheck.
- Never do leak test while smoking.

LIGHTING INSTRUCTIONS

- Open the cabinet door and put the gas cylinder into the cabinet.
- Make sure to turn the control knob clockwise to "OFF" position.
- Connect the regulator to the gas bottle.
- Turn the gas supply "ON" at the cylinder. Check with the use of soapy water for any gas leakage between the cylinder and the regulator
- Push down the control knob and keep pressing whilst turning anti-clockwise to the "Ignition" position (a click will be heard), this will light the pilot.
- If the click is not heard repeat this process. Note that when first connecting heater to the gas cylinder there will be air in the gas hose or the rest of the system. Keep pressing the control valve knob for about 1 minute to purge the air and allow gas into system.
- Once the pilot burner is lit, keep the control knob pressed for 5 seconds then release it.
- If the burner does not stay alight, repeat the above steps again.
- Adjust the heat setting by turning the control knob to the 'High' or 'Low' position.
- To shut down the heater turn the gas cylinder valve or regulator switch to the 'OFF' position and then turn the control valve knob on the appliance clockwise to the 'OFF' position.

WARNING:

If the burner fails to ignite, turn the control valve knob 'OFF' (clockwise) and turn the gas cylinder valve 'OFF'. Wait for five minutes before attempting to relight with ignition sequence.

AFTER USE & STORAGE

- Turn the control knob on the appliance clockwise to the 'OFF' position.
- Turn the gas supply off at the cylinder.
- Do not leave the area until flames have fully extinguished.
- Children must not be left unattended straight after use as the appliance will still be hot for some time.
- Check gas valve for tightness and damage. If damage is suspected this must be changed by a qualified technician.
- Always store gas cylinders in well ventilated areas.
- Once heater has cooled down it can be moved to alternative location such as garage or shed.
- Once heater has cooled down it is safe to use rain cover for protection.

CLEANING & MAINTENANCE

- Ensure all cleaning is done whilst heater is turned off and fully cooled down.
- Wipe surfaces with a soft, damp cloth.
- Do not use any corrosive or combustible cleaning solutions.
- Keep the outdoor fire covered when not in use to stop rain from blocking the burner jets.
- Make sure burner is kept clean and clear of combustible materials and dirt.
- Soot can build up on the glass beads, lava rocks and ceramics logs. This could block burner jets so remove the fuel bed and wipe with damp cloth to clean soot.
- Soot can build up on the surrounding safety glass. Carefully remove the glass from glass bracket with relative screwdriver, wipe soot with a soft, damp cloth, then carefully replace. Two people maybe required disassembly and reassembly of the surrounding safety glass.
- Ensure the condition of gas hose is suitable and shows no signs of cracking or general wear & tear.
- It is advised to get the appliance check by a qualified technician every 3 years.
- If the burner jets do get blocked by soot or other dirt then remove the fuel bed and use a pin or paperclip. Ensure the burner is switched
- Follow the above maintenance steps on a regular basis.

TROUBLESHOOTING CHECKLIST

Pilot will not light or stay on

- Ensure gas supply is turned on and cylinder is not empty.
- Press ignition button several times. Ensure to keep the main gas lever pressed in for at least 10 seconds.
- If the ignition button stays stuck in then lubricate with WD40 whilst the heater is not lit.
- Keep trying as air can get trapped in pipes and can take some time to purge all the air out of the system.
- Check that glass or lava rocks or other debris are not covering the pilot.
- Check to see if any connections are loose and tighten if required.
- Check to see if there is a leak in the gas hose. Replace if required.
- Try lighting the pilot with a match or lighter if the spark electrode is wet or damaged.
- Ensure that the appliance is on level ground and completely vertical as the 'Overturn Shut Off Device' may have been triggered.

Burner will not light

When the pilot is lit, there should be no reason the main burner would not light.

- If the pilot is lit but the burner does not light check if too much glass or lava rock is around pilot assembly. This could block the pilot light from igniting the main burner.
- If the pilot is lit but the burner does not light there could be damage to the control valve. This would need replacing by a qualified technician.
- If the pilot is not lit the flame failure device has cut off the gas supply. Wait 3 minutes, then try relighting the pilot.
- Ensure that the appliance is on level ground and completely vertical as the 'Overturn Shut Off Device' may have been triggered.

Main Burner suddenly goes out.

- If the pilot is extinguished for any reason (sudden gust of wind or it started raining) then the main gas supply would automatically cut off.
- Turn the control lever to the 'OFF' position, and leave for 3 minutes before relighting the pilot.
- Once the pilot is lit the main burner will work.
- The gas cylinder maybe empty. If so, replace the cylinder with a full one.
- Ensure that the appliance is on level ground and completely vertical as the 'Overturn Shut Off Device' may have been triggered.

SPARE PARTS

001A	Top glass
001B	Side glass
001B(Logo)	Side glass with logo
001C	Top glass clamp
001D	Bottom glass clamp
008	Pilot
009	Alu pipe assembly
010	Injector assembly
011	Gas valve with adapter
014	Overturn shut off switch
016	Knob
018	Wheels without brake
019	Wheels with brake
024	Glass beads/set
025	Lava rock/set

Note:(If applicable)

Press down break on castors(see below picture)hearer will not move.

Open:

Locked:

**Overturn shut off device(If applicable)**

We also have overturn switch on the product.It will shut off gas supply to pilot when the heater fall down.

(Overturn switch see below picture.)For Kongur 425P,Kongur 425T,Q9,Lhotse 817 which do not fitted with overturn switch.Please pay more attention to the product stability when in use.

**Warning:**

What to do after glass on heaters broken:

- a. If the heater is not in use, please dont touch splinters with hands, clean all splinters with tools to avoid anybody be injured. And ask a professiona man for installation of new glass.
- b. When it happened in use, please turn off the cylinder and control valve immediately, clean all splinters with tools to avoid anybody be injured. And ask a professional man for installation of new glass.

ITALKERO WARRANTY

All ITALKERO. gas fire appliances are covered by a 24 month limited warranty. Should there be any problems, please contact the retailer or supplier from where the appliance was purchased. Please quote serial number, which can be found on the label on the back side of door.

1. The warranty protects the appliance for the end user against defects in materials and workmanship for the period of one year, which begins on the date of purchase by the customer.
2. Under the warranty the end user is responsible for the cost of packaging and shipping the unit to ITALKERO. ITALKERO are not liable if the appliance is improperly packed resulting in damage during transit. Please retain all original packaging together with manuals, as this will assist in returning the product in the correct packaging.
3. ITALKERO will rectify the fault within a reasonable amount of time from the point of receipt at our factory.
4. The warranty covers only those defects which arise as a result of normal use of product, and do not apply to any: a) Improper and inadequate maintenance or modification; b) Repairs carried out by non-qualified technician; c) Damage caused by improper handling or installation; d) Operation outside the product specifications; e) Physical damage, accidental damage, neglect, or user abuse; f) Normal wear and tear.
5. If there is no fault found or the problem has been caused by third party, user error or physical damage and any of the reasons stated in section 4, a 'no fault found' charge and then any subsequent transport costs will be applied. Confirmation this charge will be given within 14 days of the item being tested.
6. The warranty applies to the original owner of the appliance and is non transferable.
7. ITALKERO reserve the right to repair or replace any faulty components. Faulty goods may be replaced with factory-refurbished products.
8. The warranty is void if, there is any attempt made to repair the system by a non-qualified third party, or if the system is inadequately or improperly maintained or modified All repairs and replacements will carry a 90 days warranty or the original warranty balance, whichever is greater.
9. ITALKERO reserve the right to replace discontinued products that are still under warranty with the nearest equivalent specification product.
10. This document is not proof of purchase or proof of warranty. Retain your proof of purchase.
11. Total liability extends only to the purchase price paid for the appliance, except where such a limitation is prohibited by statute.
12. ITALKERO, in the event of a warranty claim, reserves the right to either replace the appliance in question or to refund the purchase price of the appliance.

Goods Damaged in Transit

If goods are visibly damaged on receipt, it's important to sign for the goods as damaged on arrival with the courier and then contact the retailer or supplier immediately.